



JILALAN

MONTHLY CIRCULAR OF THE BRISBANE

CATHOLIC BUSHWALKING CLUB

UNDER THE GUIDANCE OF OUR LADY OF THE WAY



Registered in Australia for transmission by post as a periodical

Price 10c

CATEGORY B

SEP 1972

JILALAN

CLUB ADDRESS: P. O. BOX 151, North Quay, Brisbane, 4000.

Monthly General meetings are held on the third Monday of each month in the Temperance Hall, Canberra Hotel (Edward St.) entrance), at 7.30 p.m. Visitors welcome.

	<u>OFFICE BEARERS</u>	
CHAPLAIN:	Fr. Leo Coste	522069
PRESIDENT:	Brain McMahon	913532
VICE PRESIDENT:	Russell Nelson	702170
GENERAL SECRETARY:	Marnie Conway	360361
OUTINGS SECRETARY:	Tom Plunkett	598646
TREASURER:	Denise Thompson	
SOCIAL SECRETARY:	Linda Platten	981689
SAFETY & TRAINING	/Monica Eienberg	953722
COMMITTEE MEMBERS.	Mardi Clifford	971018
	Garth Comerford	64707
	Brian Hanvin	
	Peter Herzog	
EDITOR:	Anthony Elliot	
EQUIPMENT HIRE:	Russell Nelson	702170
FEDERATION DELEGATES:	Kath Vingoe	486178
	Peter Herzog	

FEDERATION ADDRESS: The Queensland Federation of Bushwalking Clubs, G.P.O. Box 1573, Brisbane, 4001.

Emergency Officer

Where a party is overdue, the onus is on parents to telephone the emergency Officer if they are concerned over their son/daughter's safety. The Emergency Officer is listed under each trip. Please do not ring before 9p.m. at the earliest.

SEPTEMBERJILALANPAGE 2

17th Sept.	ORIENTEERING	
18th SEPT.	GENERAL MEETING	
29th Sept-1st Oct.	S&T WEEKEND	
6th-8th Oct.	BLACKFELLOW FALLS	T'WALK-B'CAMP
14th Oct	SOCIAL	SUPPER DANCE
16th Oct	GENERAL MEETING	
22nd Oct	MT. BYRON	DAY WALK
3rd-5th Nov	LENNOX HEAD	B'CAMP
20th Nov	GENERAL MEETING	
1st-3rd Dec	HELL HOLE GORGE	T'WALK

CALENDER SUBJECT TO ALTERATION

NOTE: - NOMINATIONS CLOSE ON THE MONDAY BEFORE THE TRIP
OR SOCIAL.

FLASH: For the October meeting an engineer from the Environmental Control section of the Co-ordinator General Department is coming. This section has been investigating all sorts of pollution and have come up with some sound ways of improving and protecting our environment. More in October circular.

HEY! Slackness!

JIT ALAN

PAGE 3

\$ \$ \$ \$

Some people in this Club just aren't giving the Outings Secretary a fair go. I'm talking about people nominating for Club trips then not turning up or cancelling on Friday night, when transport arrangements cannot be rearranged. On the recent O'Reilly's trip there were not enough cars so a small bus was hired, only to run at a \$20 loss because several people did not show up.

This just isn't good enough. We're trying to cut trip prices down to the \$4 mark but when this situation occurs - and it isn't the first time - we find it mighty hard. At the moment there is provision in the Constitution for Committee to buy the full nomination fee when walkers cancel from trips after the Monday before the trip.

At the August Committee meeting it was decided to impose a \$1 buy on people cancelling from trips after the closing date for nominations. This will not recoup our losses but it will help and it is a deterrent to those who casually put their name down for a trip and then do not show up.

Also from now on a \$1 deposit will be required before names are taken for a trip. This is not a strong arm tactic on the part of the Committee but just plain good sense. Remember, we are all members of this Club and it is our actions and attitudes which make the Club strong.

PRESIDENT

Brian McMahon.

ROAD DIRECTIONS FOR SUPPER DANCE.

From city travel along
Samford Rd. past Keperra
Drive-in. till Glengarry Rd.
and Kedron Rd. meet Samford.
Continue up Kedron Rd. (dirt
road) till you reach the hall.
Any further information, ring
Linda Platten 981689.

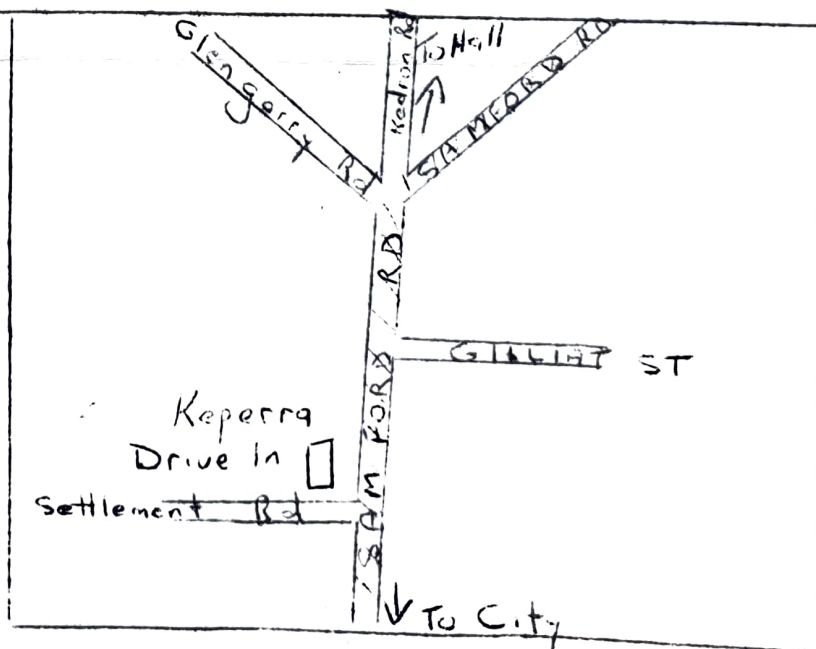

CLUB HUT WORKING BEE

22nd - 24th September

Our Club Hut on Barney Creek is about to experience some renovations. constant use over the past few years has resulted in a few items in need of repair work and the weekend 22nd - 24th September has been set aside for a working bee.

All materials will be carried in by a four wheel drive transport so it will be quite a pleasant weekend and we expect to get back to Brisbane on Sunday afternoon. We need about 10 workers to get the repairs done and some carpentry experience would be an asset; however enthusiasm is the only essential requirement.

Anyone interested in this weekend can see Brian McMahon at the September general meeting or phone 91.3532.

0-0-0-0-0-0-0-0

Orienteering

GLASSHOUSE MOUNTAINS.



Orienteering is best described as a car rally on foot. Contestants set out in troupes of two equipped with map and compass; several checkpoints are noted on the map and the teams must locate these along the course. Points are awarded on the team's performance and prizes are awarded to the teams with the best score.

For a short time before the start there will be instructions on map reading and compass work so ignorance in that respect is no problem. The competitors will be divided into two groups to cater for both fast and slow walkers. Last year most contestants had only a slight knowledge of map reading and compass work but only one team went astray and all the girls finished the course. The course takes a few hours to walk and afterwards there is a barbeque and presentation of prizes.

0-0-0-0-0-0-0-0

FEATURE FOR SEPTEMBER MEETING

.....a film on survival of a group of men who parachute into dense jungle. Starring Eliot Ness, Lloyd Bridges and Flipper. Don't miss it! K-rations, cookies and gum leaf tea served afterwards.

(IF YOU THINK THIS IS CROOKED, GET YOUR EYES TESTED)

CALENDAR IN CLOSE-UPORIENTEERING

Date: 17th Sep.
Price: \$2.50
Time: 9.00 a.m.
Leaves: North Quay Behind Trittons
Leader: Brian Mc Mahon.
Emergency Officer Russell Nelson.

SAFETY & TRAINING WEEKEND.

Date: 29th Sept - 1st Oct.
Price: \$4.50
Time: 7.00 p.m.
Leaves: North Quay behind Trittons
Leader: Monica Fienberg.
Emergency Officer: Marnie Conway.

BLACKFELLOWS FALLS

Date: 6-8th October..
Price: \$5.00
Time: 7.00 p.m.
Leaves: North Quay behind Trittons.
Leader: Tom Plunkett.
Emergency Officer: Marnie Conway 360061

Blackfellows Falls

This is an area which was last visited in October 1967. The actual falls are situated at the junction of the Mistake Range and the Main Range, north of Cunningham's Gap. These are excellent 300 degree views of the scenic rim, including Mt. Castle. The vegetation is open rain-forest and quite interesting.

Safety & Training Week-end

The site of the next safety and training week-end is to be Lost World (near the YHA hostel) on the Albert River. Adequate exploration of this beautiful area, in the shadow of Mt. Widgee, will be included with normal safety and training activities, on this week-end.

Safety & Training Week-end (cont)Requirements

Normal week-end equipment

Song books

Small water bottle (water is available at the campsite.)

Camera.

Nominations are required at least one week beforehand to Monica Fienberg.

Please note.

Club Contact officers and members of the committee must not be rung after 9 p.m. unless there is an emergency. Consideration must be given for the families involved.

OUTINGS IN RETROSPECTBarney Mass

Eight of us left North Quay at about 8 p.m. on Tuesday in a bus that takes twenty-five. After a stop at the Lindesay Diner we reached Yellowpinch at 11.15 p.m. At this point four of us decided to proceed up Peasants ridge that night while the others remained and set up camp.

The party that went up Barney on Tuesday night got to the hut at about 8.00 a.m. after numerous rest stops including one of four hours where the leader had a sleep. In the mean time eleven walkers arrived from Brisbane at Yellowpinch at 8.00 a.m. Then ten of them proceed to go up Peasants. It rained quite heavily during this period much to the discomfort of those going up Peasant. The Tuesday night walkers at this stage were fast asleep in the hut.

At about noon, the first of day walkers arrived, so disturbing the sleep of the night walker. All the day walkers were there by 1 p.m. including John Mc Cann of Urbenville, N.S.W. Mass was then said by Father Leo Coote in the hut as it was still raining at that time.

After mass some continued having lunch while those who came in the bus left for Yellowpinch. We were all down by 4 p.m. and the bus arrived back in Brisbane just after 7 p.m.

As far as attendance goes it was rather a poor effort by club members. There were nine members and eleven visitors. This was a poor role up for an annual event such as this especially when you consider the financial membership is at least fifty five.

The Fraser Island Reserve.

This reserve began when 52 aborigines from Maryborough were removed there on a lugger by Archibald Meston early in 1897. Yet Meston did not halt here; soon he was collecting aborigines from numerous Queensland centres so by 1901 217 had been sent to the island.

No attention was given to the Aborigines' crucial connection with their local environment. To be torn away from this was to lose all connection with the past, all harmony with the present and to place the future in jeopardy. He ignored elderly aborigines pleas that they would rather be "shot than removed", claiming this was sentiment and children's thoughts.

No allowance was made for the fact that he was intermixing usually hostile tribal groups and destroying the final remnants of their identity. In April 1898 he claimed to have representatives of 10 different tribes on Fraser Island but there were undoubtedly more.

Meston alleged that in order to cure, care for and re-adjust aborigines, some sacrifices had to be made - but what evidence is there of shelter, medicine, hygienic care, balanced diet, education and training?

The death rate was accelerating. 57 out of 217 aborigines died 1897-1901 -(a 25% death rate); 35 of those in the 14 months from February 1900. In 3 years only 5 aborigines had been sent to Maryborough hospital. When Church of England missionaries took control of the reserve in 1900, they had to make a plea for basic first aid items like pain-killer, cough medicine and camphor lotion. No doctor visited the Island. Sickness was rampant and in 1899, a case of leprosy was discovered. In 1900, aborigines were reported to have died from consumption, syphilis, cancer of the throat, convulsions, poisoning, opium smoking. In 1901 "a hasty examination" of some inmates by Dr. Penny found numerous other cases.

The reason for his visit was the alarming persistence of natives at clay eating and earth eating. 6 died from this 1899-1900 and in February 1901, he found 6 more cases in an advanced state of the disease, a form of acute anaemia produced by a worm in the intestines. This was induced in turn by bad sanitation and poor diet. After 6 months his visits were stopped by the Government although it was warned successful cases would "droop again" and "fresh cases constantly arise".

Penny had revealed sanitary conditions to be bad, natives were living in "gunyahs" and defaecating nearby; the diet

The Fraser Island Reserve. cont.

provided being no more than maize meal porridge with no meat, milk or vegetables. The disease reasserted itself but was seemingly kept at bay in 1903.

In 1902 it was decided to remove the children to Little Woody Island away from "the contaminating influence of the adults". This island was one of the chief sources of the clay ("dulong"). In 1903 Mary Gribble wrote that adult blacks were still eating the clay, "but we have stopped the supply to children. The children eat sand, charcoal, brick, chalk, shell and slate pencil." (Dr. Penny had written earlier that the endemic form of disease occurred when patients did not confine themselves to clay.)

What happened to the inmates of this reserve? Captain Kent revealed, Here are a list of a few who died under terrible conditions in odd corners. No doubt the protector's department can actually double the list:

Clara	Amelia
Sara Carke	Ellen
Mary Ann	Stella
Nellie	Rosy Johnson
Kitty Lang	Jack Foxton's Wife
Topsy	Albert
Mary Pentecost	Frank
Bella	Willie Walker
Nancy Wilson	George Lem
Old Kitty Sader	Willie Normanton
Maggie	Paddy
Elsie	Neddie
Charlie	Bellie Ben

As far as I can gather most of this lot died in the Maryborough district.... A terrible list... Isn't this one of the blackest pages in the history of the British Empire?"

The majority of the inmates were transferred to Yarrabah - amongst them the incurably ill.

Coupled with their sickness, the Bogimbah people were regarded as the "children of sin" giving in 1904 a great deal of trouble by absconding to Cairns. Gradually, the rest of the Fraser Island people died, were absorbed at Yarrabah, or followed onto Fitzroy Island.

In 1910 Police Magistrate Grant visited Fitzroy Island finding 10 married couples, 3 single girls and an old woman claiming to be a remnant of the Fraser Island Mission." The promise of the "properly appointed and attractive reserve" had assumed in reality the form of the concentration camp

The Fraser Island Reserve cont.

and prison. It was extinction on the cheap - the "final solution" by neglect and default.

Judy Russell.

MORE BEAUT SCANDAL.

Bill Conway had an unexpected visitor in his tent on the O Reillys weekend; after a frantic struggle out of his sleeping bag he abandoned his tent to the marauding paddy melon and found refuge in the trailer of the bus.

Four basecampers recently found out how Blue Pool got its name. Slides at next meeting. (Blue is the colour of an oxy-acetylene flame.) Ed. note

Well, If have'nt anything to read here, go out and do something outrageous.

Well as the sun sets and Thomas Plunkett is escorted away we must say good-bye.

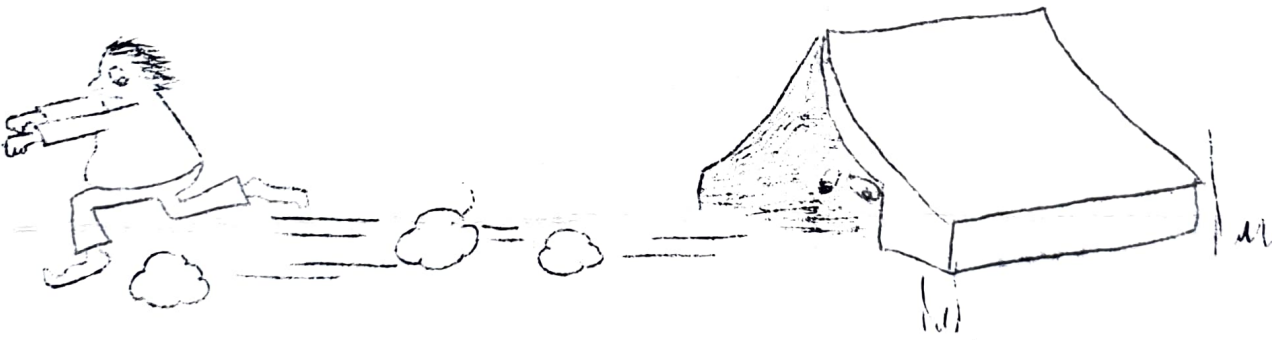

BARRANI

"Barrani" is an aboriginal word meaning "walking" - and the title of our annual magazines. Despite an absence of several years Barrani is being produced this year with a production date of around December. So far, we have about half of the material needed but short stories, jokes, poetry, etc., are still needed.

What can you offer? Articles can be a few lines to a few pages and topics are virtually limitless - I mean, what really went on in that ten shed during the cyclone threat on Fraser Island? Everybody is dying to know a successful damper making technique or the ingredients for a truly Supperscroggin. If you have something for Barrani (or maybe you'd just like to dob someone in!) see me at the general meetings or call me on 913532.

Brian McMahon.

CHOOFER RAFFLE

Win a fabulouw gas choofer in our choofer raffle - as used by President and Outings Secretary. Guaranteed easy to use and supplied with a full container of gas. Tickets a mere 20c and on sale at September meeting and Club trips and socials. (Remember, if you already have a choofer you can easily sell this one to other club members).

Choofers)- the most essential non-essential for every walker.



Burnt hand
of Vice
President who
has not got a
'Choofer'.

BRISBANE CATHOLIC BUSHWALKING CLUB MONTHLY CIRCULAR

NOMINATION FORM (Trips or Social)

To: Brisbane Catholic Bushwalking Club, P.O. Box 151, Brisbane
North Quay, 4000

I hereby nominate for.....

to be held on.....

I nominate..... as a visitor on the
above outing/social.

I/we enclose postal order/money order/cheque for \$.....
this being the specified nomination fee.

I/we undertake to abide by the Constitution and By-Laws of the
Club. The Club or its agents does not accept any liability for
injury, loss or damage suffered or caused by any Member,
Prospective Member or visitor whilst participating in the Club's
activities.

Member's signature.....	Visitors Signature.....
Phone - home.....	(If under 21)
work.....	Signature of Parent or Guardian.....

NOMINATION FORM (Trips or Social)

To: Brisbane Catholic Bushwalking Club, P.O. Box 151, Brisbane,
North Quay.

I hereby nominate for
to be held on.....

I nominate as a visitor on the above
outing/social.

I/we enclose postal order/money order/cheque for \$
this being the specified nomination fee.

I/we undertake to abide by the Constitution and By-Laws of the
Club. The club or its agents does not accept any liability for
injury, loss or damage suffered or caused by any Member,
Prospective Member or visitor whilst participating in the Club's
activities.

Members Signature	Visitors Signature
Phone - home	(if under 21)
work	Signature of Parent or Guardian
